

Working methods

Microcement AQUA QUARTZ CimentArt

Essential tools for applications

- Protective tape
- Scissor or cutter
- Sander
- Sandpaper grit 40
- Sandpaper grit 120 – 150
- Spatula
- Steel trowel
- Microfiber roller
- Painting Pan
- Electric mixer
- Vacuum cleaner
- Measuring glass or digital scale

Necessary CimenArt products

- CimentArt Primer
- CimentArt Fiberglass mesh
- Microcement base AQUA CimentArt
- Thin microcement AQUA QUARTZ CimentArt
- CimentArt sealer
- Bi-component Polyurethane varnish CimentArt (Component A and B)

Before starting

Check the surface where the product would be apply and make sure the surface is:

- Straight
- Stable, motionless
- Dry and without humidity
- Clean
- Free of dust, grease, etc

Step-by-step application

1. Place the protective tape where necessary

- For the application over completely smooth walls, do only steps 2, 4, 5 and 6.
- In the case of application on floors and walls in bad conditions or with tile joints do all the steps.

2. Extend the Fiberglass mesh CimentArt over the Surface



3. Apply a layer of CimentArt Primer with a roller over the fiberglass mesh, or in the case of completely smooth walls apply the layer over the Surface.

Grupo CimentArt

Avenida Carrer La Mar Nº 12 · 03560
El Campello · Alicante · SPAIN

(+34) 965 654 637 · info@grupocimentart.com
www.grupocimentart.com





- Clean the roller and the painting pan with water

4. Microcement base AQUA CimentArt

- The product is provided ready to be used; we recommend mixing the product using a spatula or electric mixer to obtain a complete homogenization of the color.
- The coverage is 1 kg/m² for a layer of 1mm, been always necessary to apply 2 layers. Therefore, 2 kg of Microcement Base Aqua will be required to use the product on a surface of 1 m².



Application of the first layer of Microcement Base AQUA:

- With the steel trowel, using an angle of 45° giving a thickness of 1mm maximum (the thickness given by the grain of the mixture and by the pressure used during the application).
- Complete the first application making it as homogeneous and without irregularities as possible.



- Remove the protective tape before the Microcement hardens.



Allow the Microcement Base AQUA to dry completely:

- The drying time depends on the humidity, temperature, ventilation, etc.
- Remove the irregularities of the first layer of Microcement Base AQUA with a spatula or with sandpaper grit 40.
- Remove the sanding dust. Wipe the surface with a damp cloth to clean it.



Place protective tape where necessary.

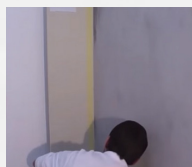

Grupo CimentArt

Avenida Carrer La Mar N° 12 · 03560
El Campello · Alicante · SPAIN
(+34) 965 654 637 · info@grupocimentart.com
www.grupocimentart.com



Apply the second layer of Microcement Base AQUA.

- With the Steel trowel, using an angle of 45° giving a thickness of 1mm maximum (the thickness is given by the grain of the mixture and the pressure used during the application).
- Complete the first application making it as homogeneous and without irregularities as possible.
- Tip: the first layer as well as the second can be spray with water and slightly pass the steel trowel to correct the irregularities.



Remove the protective tape before the Microcement hardens and allow the complete drying of the second layer of Microcement Base AQUA.

- The drying time depends on the humidity, temperature, ventilation, etc.

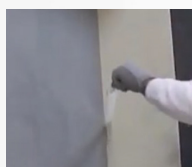

- Remove well the irregularities of the second layer of Microcement Base AQUA with sandpaper grit 40, until a completely smooth surface is achieve.
- Remove the sanding dust by vacuuming it. In addition, wipe the surface with a damp cloth to clean it.
- Place the protective tape where necessary.



5. Microcement AQUA QUARTZ CimentArt

- The coverage of this cement ready to be use, 100% waterproof is approximately 200 -300 gr /m2 applying the product with a layer of 0,1 mm. It is necessary to do two layers and to do a surface of 1m2 between 550 and 630 grs of the product would be need it.
- The product is provided ready to be used; we recommend mixing it using a spatula or an electric mixer to obtain a complete homogenization of the color.

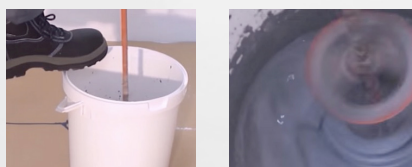

Application of the first layer of Microcement AQUA QUARTZ:

- Use a Steel trowel, with round edges, as the ones used to make stucco.
- The application is done with short movements and layers of 0,1 mm of maximum thickness.
- The thickness is given by the grain of the mixture and the pressure exerted with the trowel.

Grupo CimentArt

Avenida Carrer La Mar Nº 12 · 03560
El Campello · Alicante · SPAIN
(+34) 965 654 637 · info@grupocimentart.com
www.grupocimentart.com



- Complete the first application making it as homogeneous and without irregularities as possible.
- Remove the protective tape. Allow the first layer of Microcement AQUA QUARTZ to dry completely.
- The drying time depends on the humidity, temperature, ventilation, etc.



- Use sandpaper grit (120- 150) on the first layer of Microcement AQUA QUARTZ to correct any irregularities.
- Remove the sanding dust with the help of a vacuum.
- Tip: before applying the second layer on high temperature environments, spray slightly with water. This will allow a better application.

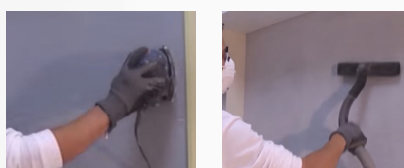

Place protective tape where necessary.

Apply a second layer of Microcement AQUA QUARTZ following the same procedure of the first layer.

- With the Steel trowel, using an angle of 45° giving a thickness of maximum 0,1 mm (the thickness given by the grain of the mixture and by the pressure used during the application).
- Complete the second application making it as homogeneous and without irregularities as possible.
- Remove the protective tape and allow the second layer of Microcement AQUA QUARTZ to dry completely.
- The drying time depends on the humidity, temperature, ventilation, etc.
- Tip: For the joints not to be visible, the last layer of Microcement AQUA QUARTZ CIMENTART must be applied in a continuous without stops fashion.



- Use sandpaper grit (120- 150) on the first layer of Microcement AQUA QUARTZ to correct any irregularities.
- Remove the sanding dust with a vacuum. Never use a damp cloth on this phase of the application process.

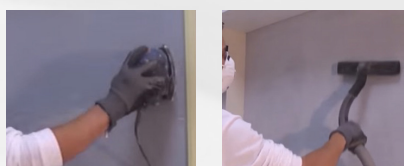

Grupo CimentArt

Avenida Carrer La Mar Nº 12 · 03560
El Campello · Alicante · SPAIN
(+34) 965 654 637 · info@grupocimentart.com
www.grupocimentart.com



6. CimentArt Sealer

- Place the protective tape where necessary.



Pour into a painting pan the CimentArt Sealer and apply a uniform layer with a shorthaired roller or a microfiber roller.

- The coverage of the CIMENTART sealer is of 100 gr/m². To use it on a surface of 10 m² is necessary 1 kg of the product.



Clean the roller and the painting pan with water.

- Allow the Sealer to dry. The drying time depends on the humidity, temperature, ventilation, etc. Often dries fast.

7. Bi-Componente water base polyurethane varnish CimentArt

Bi-Componente water base

Recommended for: Indoors and outdoors applications, in every wall, ceiling, floor of moderate traffic.

Preparation:

- Mix 5 parts of the Cimentart Base Aqua Varnish Polyurethane component A with 1 part of the component B.
- To make 1 kg of varnish with the two components 840 gr of component A and 160 gr of component B are need it.
- The approximate coverage is of 50 gr/ 1m², applying a thin layer of 0,1mm. Is always necessary to apply two layers. To complete a surface of 10 m² with two layers approximately 1 kg of the mixture is necessary.

Varnish HARD Polyurethane bi-component CimentArt Solvent

Recommended for: indoors and outdoors applications on floors of intense traffic.

Preparation:

- Mix 2 parts of the Component A of the Polyurethane Varnish HARD CIMENTART Solvent Base with 1 part of component B.
- To make 1 kg of Varnish HARD with the two components 666 gr of component A and 333 gr of component B are necessary.

Grupo CimentArt

Avenida Carrer La Mar N° 12 · 03560

El Campello · Alicante · SPAIN

(+34) 965 654 637 · info@grupocimentart.com

www.grupocimentart.com



- The approximate coverage is of 100 gr/1m², applying a thin layer of 0,1 mm. it is always necessary to apply 2 layers. To complete a surface of 10 m² with one layer 1kg of the mixture is necessary.



- Using a microfiber roller or a spray apply a first layer of varnish, 0,1mm of thickness (tipping off the surface when using the roller) and let dry at least 12 hrs.
- Using microfiber roller or a spray apply the second layer in the same fashion of the first one
- A third layer can be apply for more protection, mainly on those areas exposed to water like showers or outdoor terraces.
- Do not forget to clean the roller and the painting pan with water or a solvent, depending of the varnish used.

Important

- Microconcrete AQUA can be use on any Surface with the exception of those surfaces that have capillary humidity, pools, basements and factories with heavy machines traffic.
- Never use Microcement Base Aqua with layers over 1mm of thickness.
- Never use Microconcrete Aqua with layers over 0.5 mm of thickness.
- On places of high people traffic, like shops, offices, malls, etc., we recommend to apply a third layer of Varnish HARD polyurethane bi-component.
- Use the Varnish of Polyurethane CIMENTART always with thin layers of 0,1mm.
- Make sure all the Microcement surface is cover with the Polyurethane Varnish.
- The traditional Microcement CIMENTART can be use without any problems on showers and areas constantly exposed to water. However, for this type of surfaces the use of gama AQUA, ready to use and 100% waterproof on all its layers is recommended.

For any technical guidance write to: info@grupocimentart.com

Grupo CimentArt

Avenida Carrer La Mar N° 12 · 03560
El Campello · Alicante · SPAIN
(+34) 965 654 637 · info@grupocimentart.com
www.grupocimentart.com

